

DATE REVISED	DATE FILMED	DATE REVISED	DATE FILMED	FED. ROAD NO.	STATE	FED. AID PROJ. NO.	SHEET NO.	TOTAL SHEETS
11-1-10					ARK.		99	203
				JOB NO.	110395			
				06830	386' UNIT		47092A	

For Continuation - See Plan Sht. No. 47092

MATCH LINE

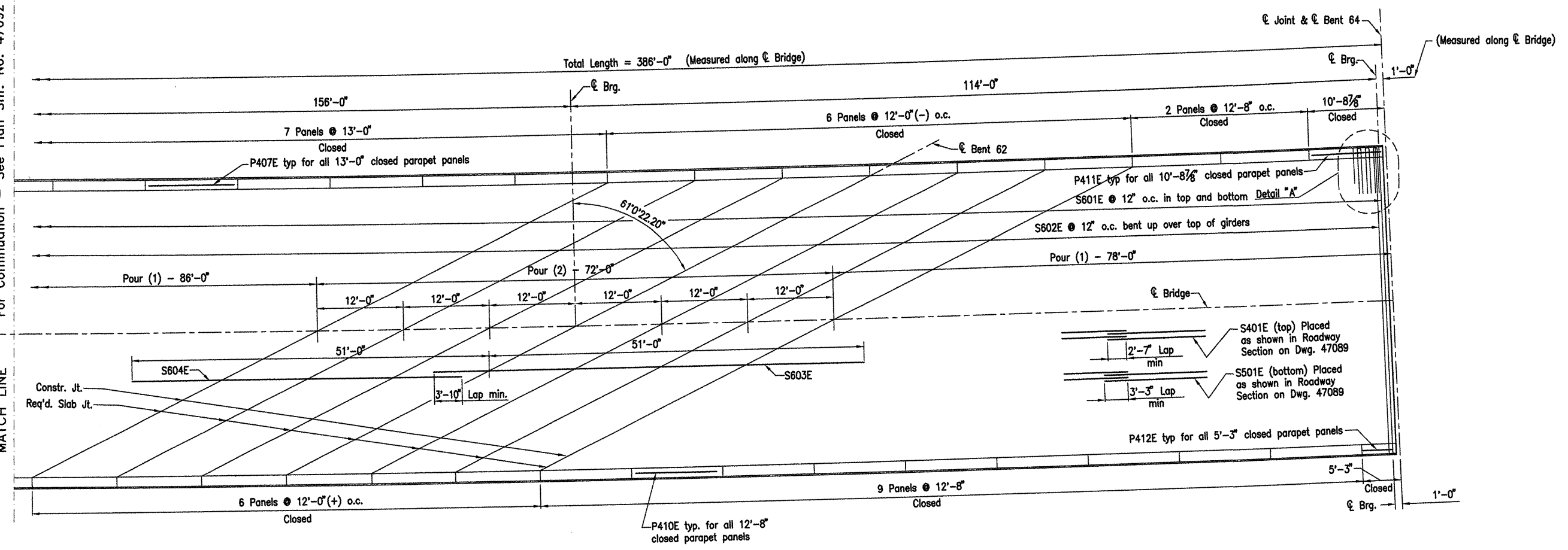

**SLAB PLAN 386'-0" CONT. COMP. PLATE GIRDER UNIT**  
 Scale: 1/8" = 1'-0"  
 Station 289+70 to Station 293+56 (1 Unit Required)

**BAR LIST - (1) 386' UNIT** Work this drawing with 47092 - Slab Plan.

Mark	No. Req'd	Length	Pin Dia.
P401E	681	6'-6"	3
P402E	681	6'-1"	3
P403E	56	5'-11 1/2"	3
P404E	56	3'-2 1/2"	3
P405E	13	11'-9"	Str.
P406E	6	5'-1"	Str.
P407E	91	12'-8"	Str.
P408E	84	11'-2"	Str.
P409E	288	11'-8"	Str.
P410E	182	12'-4"	Str.
P411E	11	10'-4"	Str.
P412E	6	4'-11"	Str.
P601E	40	11'-8"	Str.
S401E	300	41'-1"	Str.
S501E	560	41'-7"	Str.
S601E	772	42'-10"	Str.
S602E	385	43'-5"	3
S603E	136	62'-0"	Str.
S604E	136	45'-10"	Str.
S701E	772	16'-2"	5 1/4

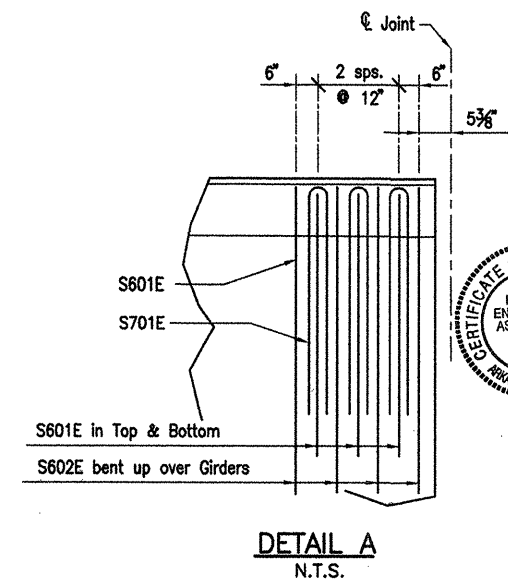
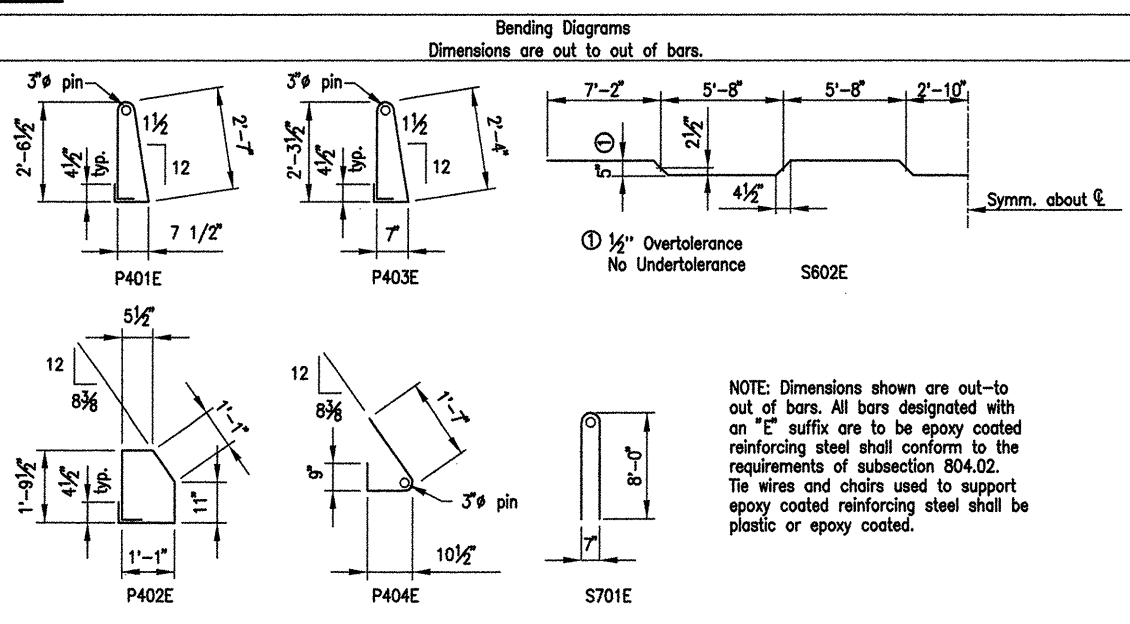

NOTE: Pours with the same number may be placed simultaneously or separately. All Pours (1) must be placed before Pours (2) can be placed. 48 hours shall elapse between the end of a pour and the start of the next pour. 72 hours shall elapse between the end of a pour and the start of an adjacent pour. Any railing pours made before the entire slab unit has been placed must be approved by the Bridge Engineer. The contractor must obtain approval of the Bridge Engineer for any deviations from the pouring sequence.

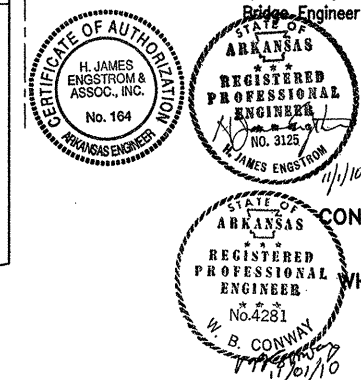

**ALTERNATE NO. 1 & 2**  
**DETAILS OF 386' CONT. COMP. PLATE GIRDER UNIT (SHEET 9 OF 11)**  
 WHITE RIVER STR. & APPRS. (CLARENDON) (PH III) (F) MONROE COUNTY  
 ROUTE 79 SEC. 13  
 ARKANSAS STATE HIGHWAY COMMISSION  
 LITTLE ROCK, ARK.

Revised Bar List by HJE/MM  
 GPT- 11-1-10

BRIDGE ENGINEER

Engstrom/Modjeski and Masters, Inc.  
 DRAWN BY: JDB DATE: Sep. 10 FILENAME: b11039514\_s08A  
 CHECKED BY: WBC DATE: Sep. 10 SCALE: 1/8"=1'-0"  
 DESIGNED BY: GPT DATE: Sep. 10  
 BRIDGE NO. 06830 DRAWING NO. 47092A